



Dash Accessory Mount (DAM) Assembly Instructions



Tools Required:

- Torx T40 screwdriver OR T40 socket and socket wrench
- 5/32" allen wrench

Included Hardware

- (1) Aluminum angled extrusion
- (2) Aluminum mounting brackets
- (2) 1/4-20 x 1/2" hex head screws
- (2) 1/4" washers
- (2) 1/4-20 Drop in T-nuts with rubber handle
- (1) 1" adhesive backed foam strip (*optional*)



Dash Accessory Mount (DAM) **Assembly Instructions**

Instructions:

1. On the driver's side of the dash, remove the top two (2) windshield bolts using a socket wrench. The factory bolts should take a T40 type Torx bit. If the bolts have not been removed in a while you may need to soak the bolts in a lubricant (e.g. WD-40, penetrating oil) to aid in removal.



2. Place the mounting bracket against the windshield plate and thread both windshield bolts in by hand. It may help to use the T40 socket manually to get the bolts finger tight. The bracket should be slid up tight to the side of the dash.





Dash Accessory Mount (DAM)

Assembly Instructions

3. Place the T40 socket onto the socket wrench and tighten each bolt until snug. Be sure not to overtighten the bolt! You do not want to strip the nuts in the windshield.
4. Repeat steps 1-3 on the passenger side.
5. Lay the angled aluminum extrusion across the dash in between the two mounting brackets. The aluminum extrusion should be oriented as shown in the photo below.



6. Using a 1/4-20 screw and washer, thread the screw into the center hole of the aluminum extrusion and finger tighten. Repeat on the opposite side





Dash Accessory Mount (DAM) **Assembly Instructions**

7. Ensure the aluminum extrusion is oriented properly and then tighten each side with the allen wrench.



8. To insert the Drop in T-Nut first grip the t-nut by the rubber handle. Angle the t-nut and place the leading edge into the attachment channel. Roll the t-nut and it will drop into the slot. T-nuts can be placed in either of the two attachment channels and can be slid anywhere along the length of the DAM.

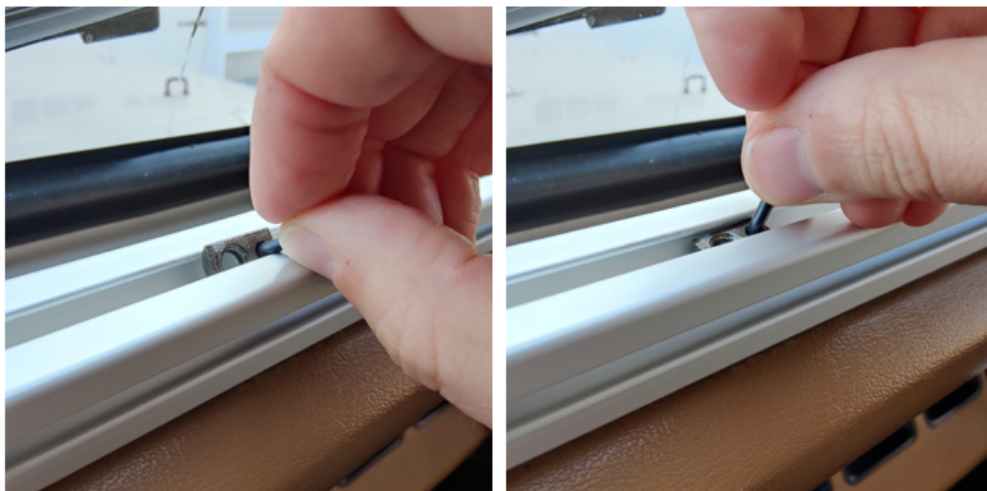



Dash Accessory Mount (DAM) Assembly Instructions

9. Any third party product with a 1/4-20 male screw base can be attached to the t-nuts. Please reach out to us directly ([email](#)) and we can help point you in the right direction.



10. *Optional:* If after installation of the DAM (and any accessories) and you notice the aluminum extrusion is rubbing on the top of the dash, peel and stick the 1" adhesive backed foam on the aluminum extrusion in the required location.



Dash Accessory Mount (DAM) **Assembly Instructions**

Note: The DAM is compatible with all Dog Fox Industries cup holders. If installing the DAM with our cup holders, then the DAM mounting bracket should be sandwiched between the cup holder and the windshield.

